

#### **Clear PVC**

The industry standard for chemical dilution systems and OEM applications, this off-the-shelf mixer is available from 3/8"–2" diameter with 6 and 12 mixing elements and male NPT ends.

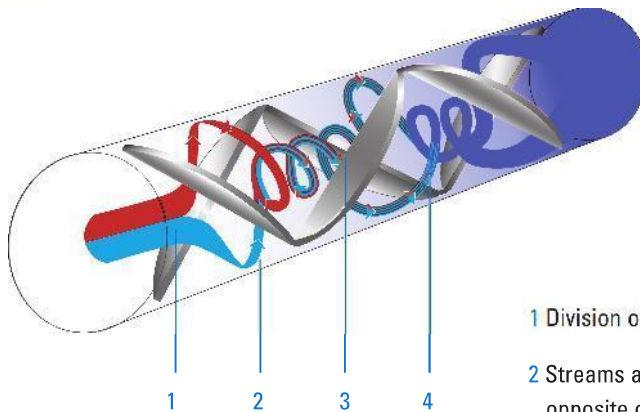

1 Division of main stream

2 Streams are forced to opposite outside walls

3 Creating a mixing vortex axial to the centerline of the second element

4 Mixing vortex shears, Step 1 re-occurs in opposite rotation

#### Benefits

- ▶ Maintenance-free
- ▶ Low pressure loss
- ▶ Open element design
- ▶ True sanitary design
- ▶ No moving parts
- ▶ No spare parts required
- ▶ Low cost
- ▶ Quick delivery

## What Mixers Are Used For



Static mixers are used to blend two or more liquids into a homogeneous mixture, or to inject a metered liquid into a continuous process stream. Applications include: water treatment (drinking water), wastewater treatment

(processing out of waste and pollutants), food processing (manufacturing of yogurt, ice cream, beverages), chemical processing, oil refining and mining/ore extraction.

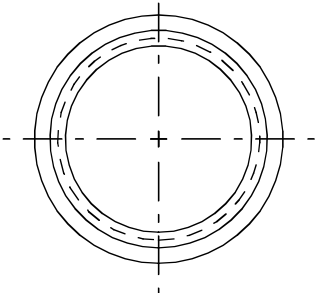
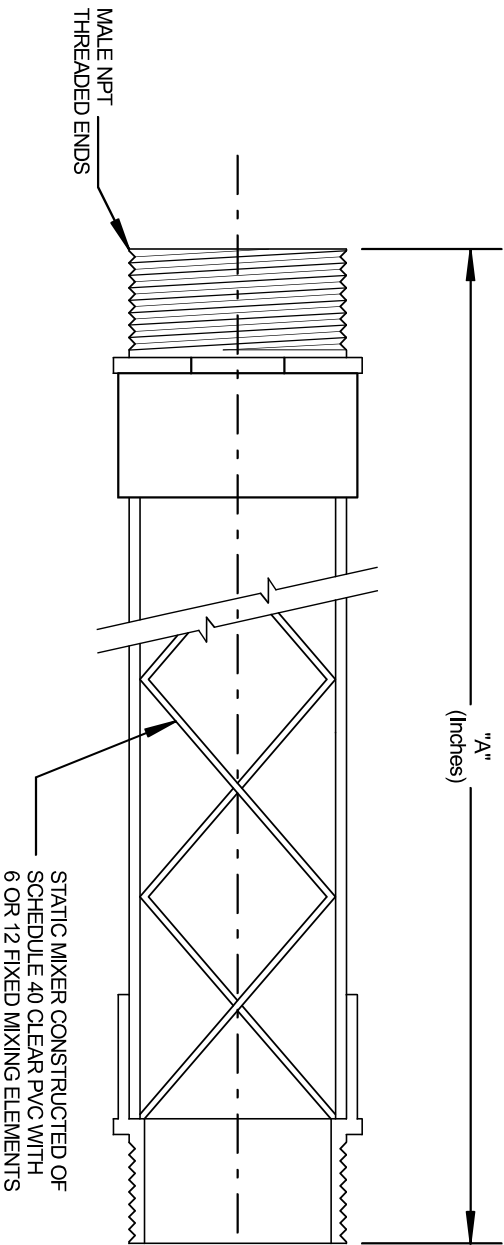

Rosca	"A" 6 elementos		"A" 12 elementos	
	pulgadas	mm	pulgadas	mm
3/8"	6 1/2"	165,10	11"	279,40
1/2"	7"	177,80	12"	304,80
3/4"	9"	228,60	15"	381,00
1"	11"	279,40	18"	457,20
1 1/4"	14"	355,60	25"	635,00
1 1/2"	15"	381,00	28"	711,20
2"	19"	482,60	35"	889,00



SCALE: NONE	APPROVED BY: <i>J.F.F.</i>	DRAWN BY: NJF
DATE: 1/18/94		REVISED: 10/15/01
CUSTOMER:		REVISED: 5/22/08
		REVISED: 6/12/09
MODEL NO.: CLEAR PVC SCHEDULE 40 MIXER		DRAWING NUMBER: KD-993

# Schedule 40 Clear PVC Threaded Mixers Maximum Pressure Ratings

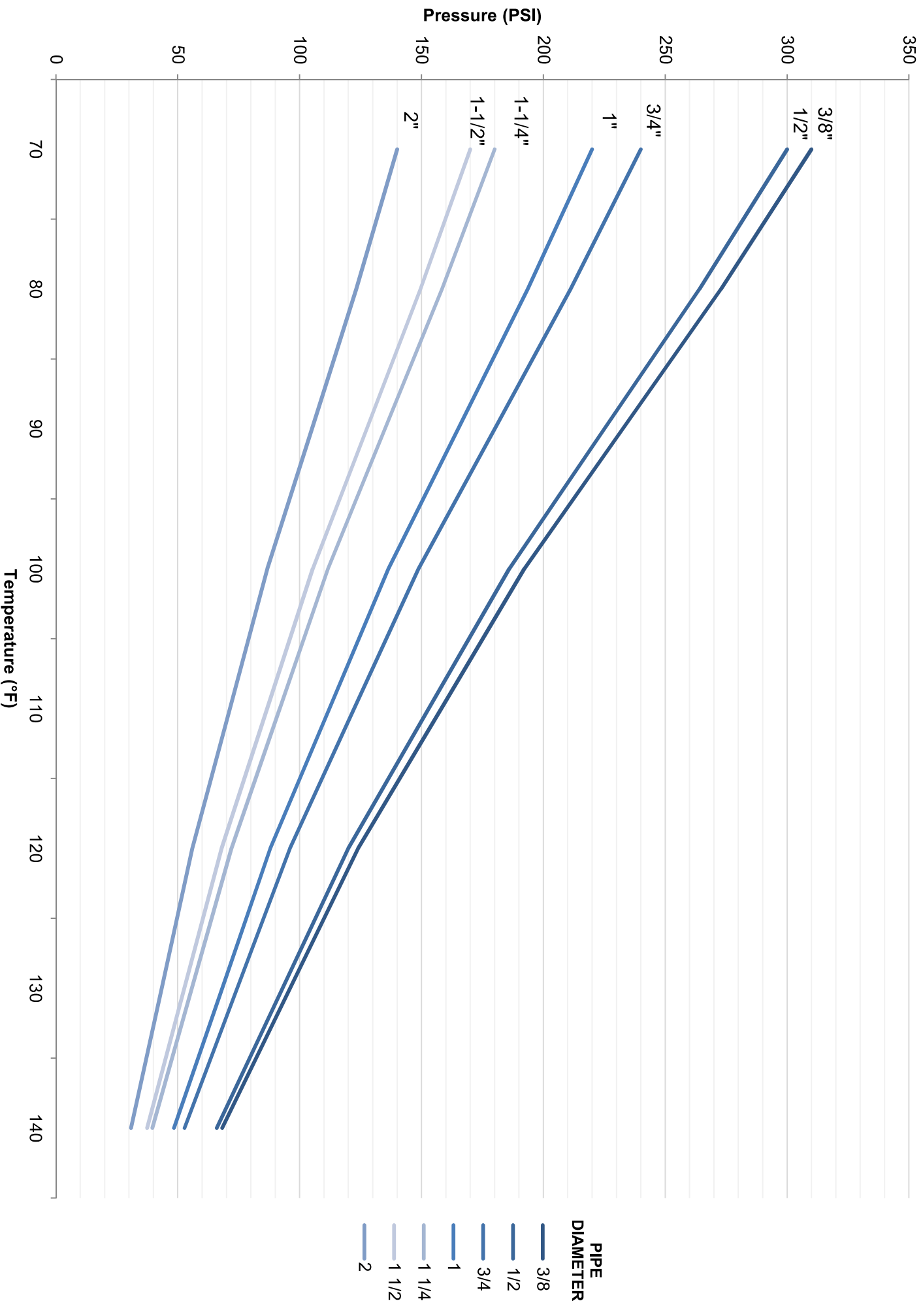

# Calibration Columns with Fixed Caps

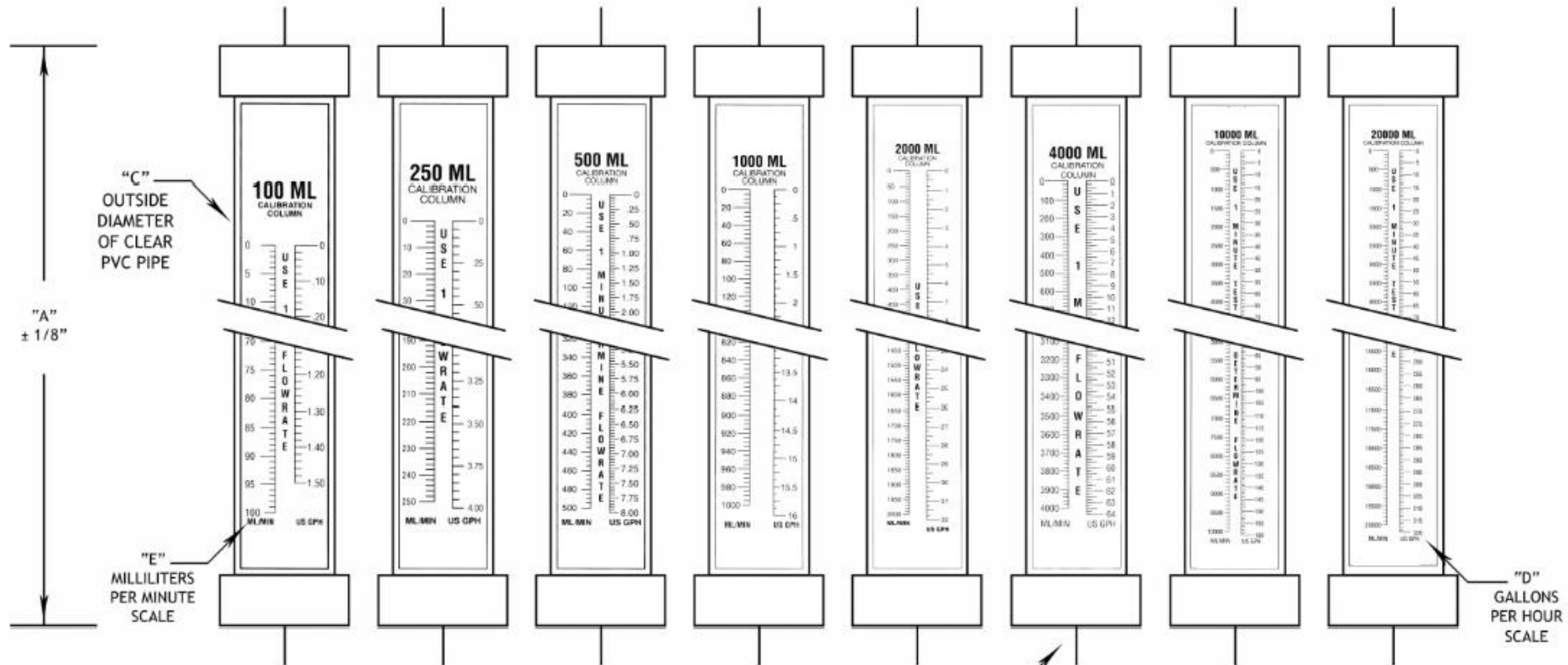

NOTE: - USE ONE (1) MINUTE TEST TO DETERMINE FLOWRATE  
 - CALIBRATION COLUMNS ARE USED IN GRAVITY SYSTEMS OPEN TO THE ATMOSPHERE AND THEREFORE ARE NOT PRESSURE RATED

MODEL	"A"	"B"	"C"	"D"	"E"	INCREMENTS
100 ML	12-1/2"	1/2"	1.315"	1.5	100	1 ML / 0.020 GPH
250 ML	16-1/4"	1/2"	1.660"	4.0	250	2 ML / 0.050 GPH
500 ML	16"	3/4"	2.375"	8.0	500	5 ML / 0.050 GPH
1000 ML	25"	3/4"	2.375"	16.0	1,000	5 ML / 0.125 GPH
2000 ML	24"	1"	3.500"	32.0	2,000	10 ML / 0.250 GPH
4000 ML	34"	1"	4.000"	64.0	4,000	20 ML / 0.250 GPH
10000 ML	27"	2"	6.625"	160.0	10,000	100 ML / 1.000 GPH
20000 ML	46"	2"	6.625"	320.0	20,000	100 ML / 1.000 GPH

"B"  
FNPT CONNECTIONS  
TOP AND BOTTOM

SCALE: NONE	APPROVED BY:	DRAWN BY: N.J.F
DATE: 2/6/07		REVISED: 8/7/07
CUSTOMER:		REVISED: 11/24/10
		REVISED: 8/14/14
MODEL NO: PVC CALIBRATION COLUMNS		DRAWING NUMBER KD-1032